

CITY SCHASLYVE

OFFICE AND LOGISTIC
COMPLEX

SCHASLYVE VILLAGE, KYIV REGION,
UKRAINE



DEVELOPER



City State, LLC

Ukraine, Kiev, 01013,
Stroyindustrii Str., 6

tel.: +38 (044) 594 91 84

fax: +38 (044) 545 75 15

ayurkevych@gmail.com

www.citystate.com.ua

GENERAL PLANNER



Prodiz, LLC

Ukraine, Kiev, 01013,
Stroyindustrii Str., 6

tel.: +38 (044) 594 91 90

fax: +38 (044) 545 75 20

v.shershun@prodiz.com.ua

angelina.davydenko@gmail.com

General data	3
Location scheme	4
General location scheme	5
Master plan scheme	6
Model	7
Territory balance sheet	8
Explication	9
Transportation scheme (excluding projected highway)	10
Transportation scheme (including projected highway)	11
Office building. 1-st floor plan. Open space planning	12
Office building. 1-st floor plan. Planning variation	13
Office building. 2-nd floor plan	14
Office building . 2-nd floor plan. Planning variation	15
Office building. Typical floor plan	16
Office building. Typical floor. Planning variation	17
Office building. Scheme of typical floor's fresh air ventilation	18

City Schaslyve office and logistic complex will be implemented in Schaslyve village, Boryspil district, Kiev region on the land parcel with total area 32,15 ha.

Complex includes:

10 typical office buildings with multilevel ground parking:

- offices total area - 180 000 sq.m
- parking total area - 84 000 sq.m
- car places total number - 3280

3 office buildings:

- offices total area - 14 950 sq.m

8 logistic complexes, which consist of warehouses and offices:

- warehouses total area - 49 970 sq.m
- offices total area - 17 955 sq.m

Public centre:

- total area - 11 910 sq.m

Hotel and recreational complex, which consist of hotel for 200 rooms and sport and recreational complex:

- hotel total area - 9 270 sq.m
- sport complex total area - 9 600 sq.m

Total office and logistic complex area:

- offices - 212 905 sq.m
- warehouses - 49 970 sq.m
- parking - 84 000 sq.m
- public centre - 11 910 sq.m
- hotel - 9 270 sq.m
- sport complex - 9 600 sq.m

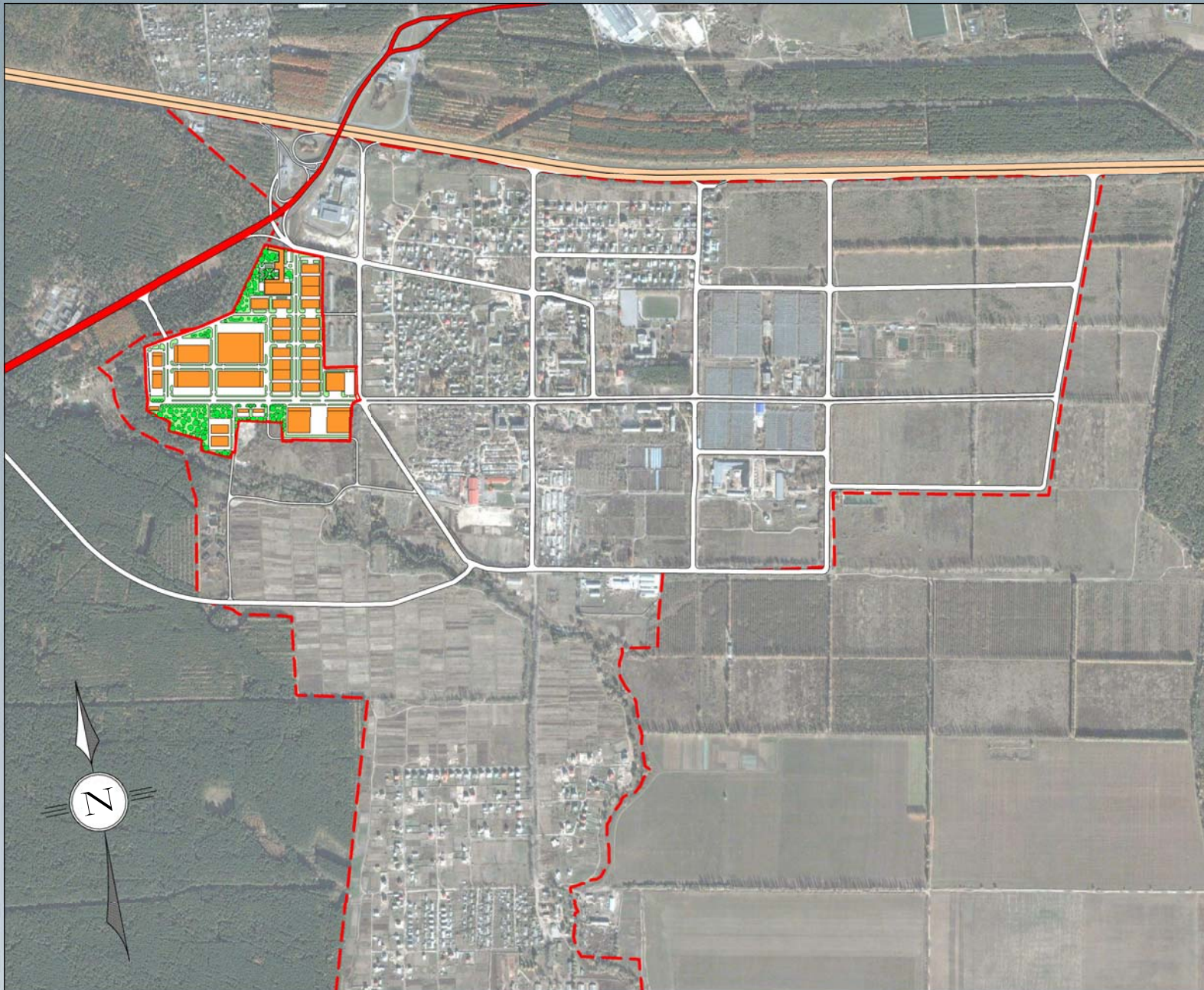

Legend:

- - - - - village borders
- Boryspil highway
- projected highway

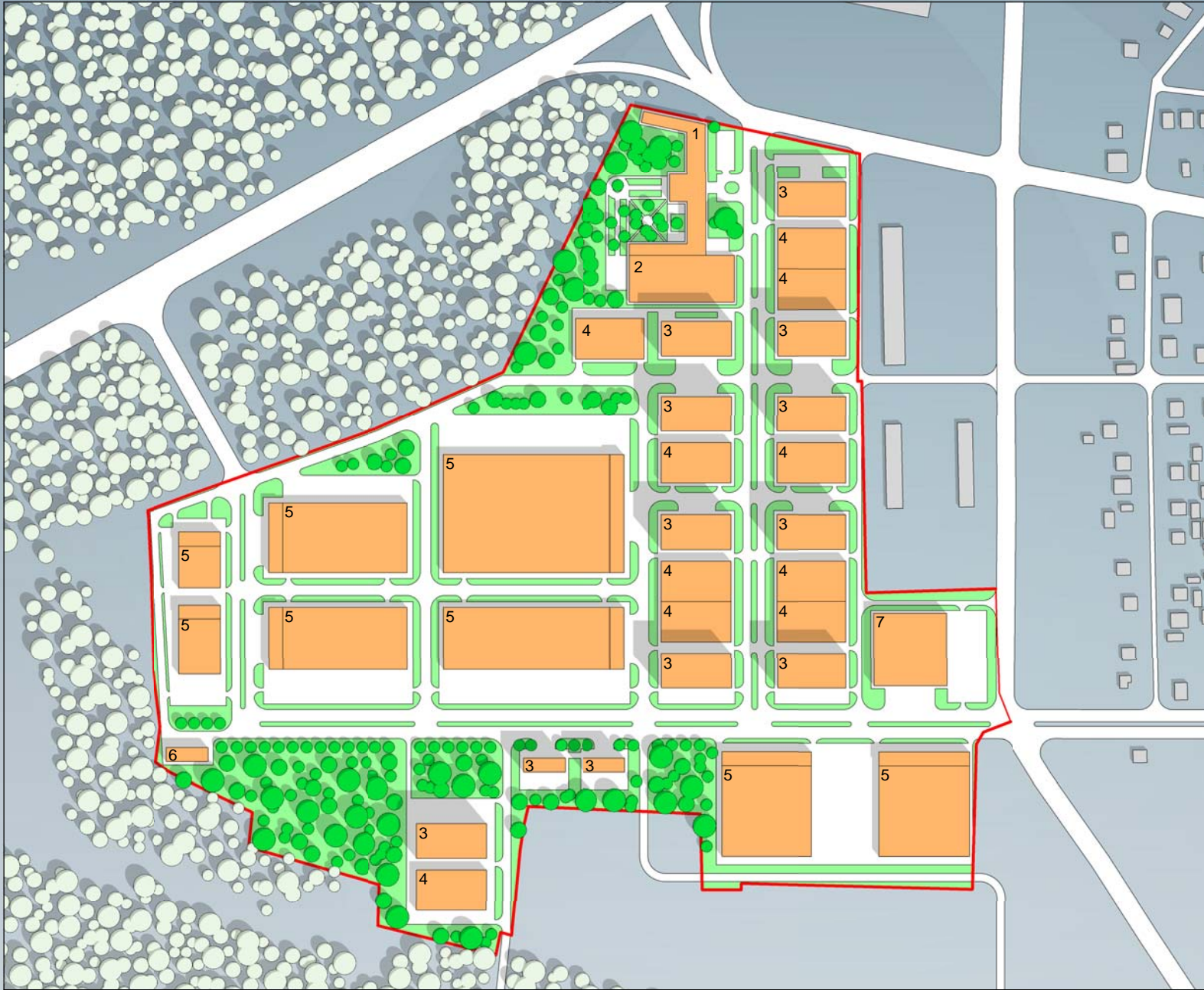

Explication:

1. Three-storey hotel for 200 rooms.
2. One-storey sport and recreational complex.
3. Ten-storey office building.
4. Parking (four levels).
5. Logistic complex.
6. Three-storey public centre.

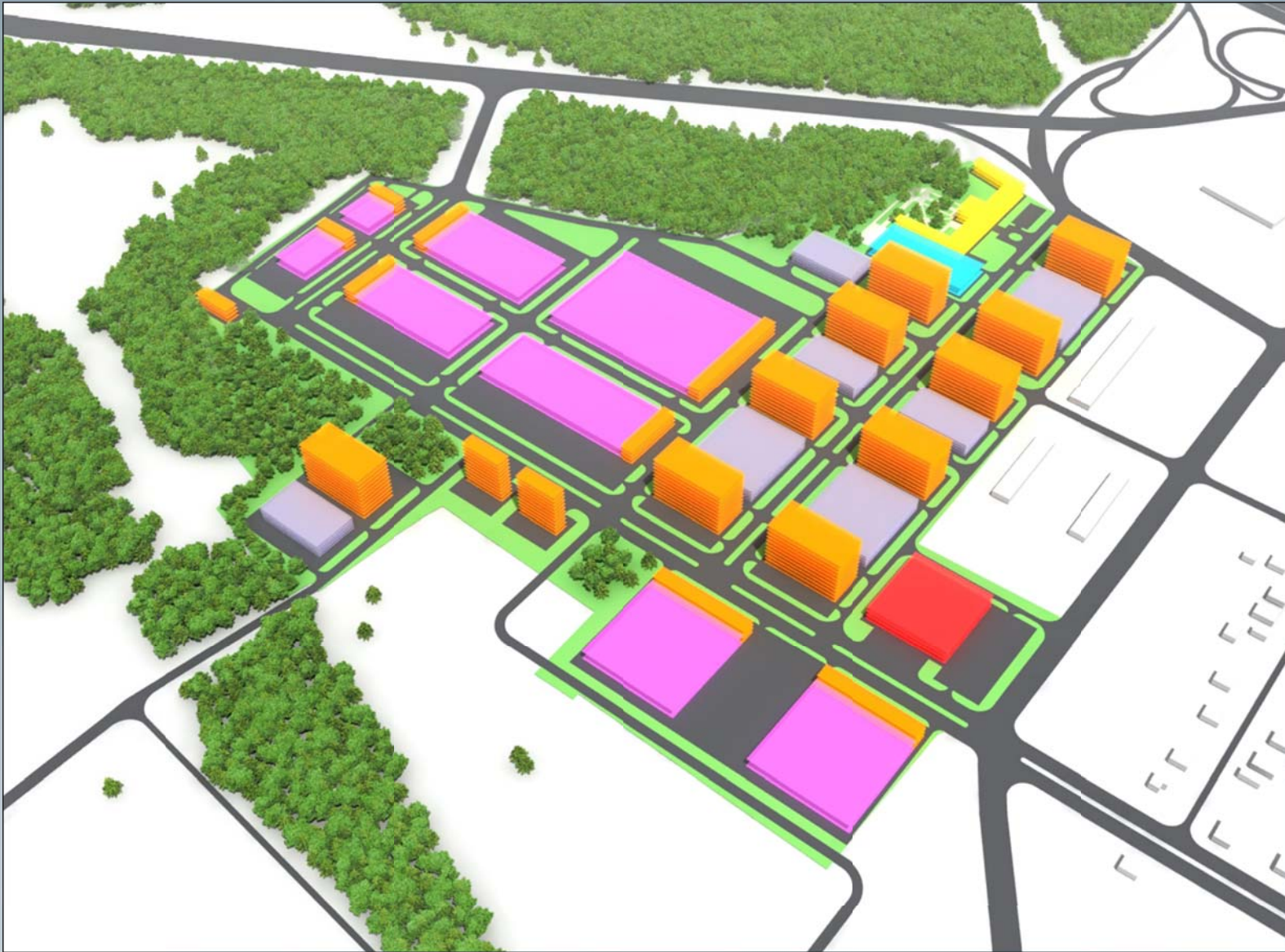

Legend:

-  - office buildings
-  - parkings
-  - logistics
-  - hotel
-  - sport complex
-  - public centre

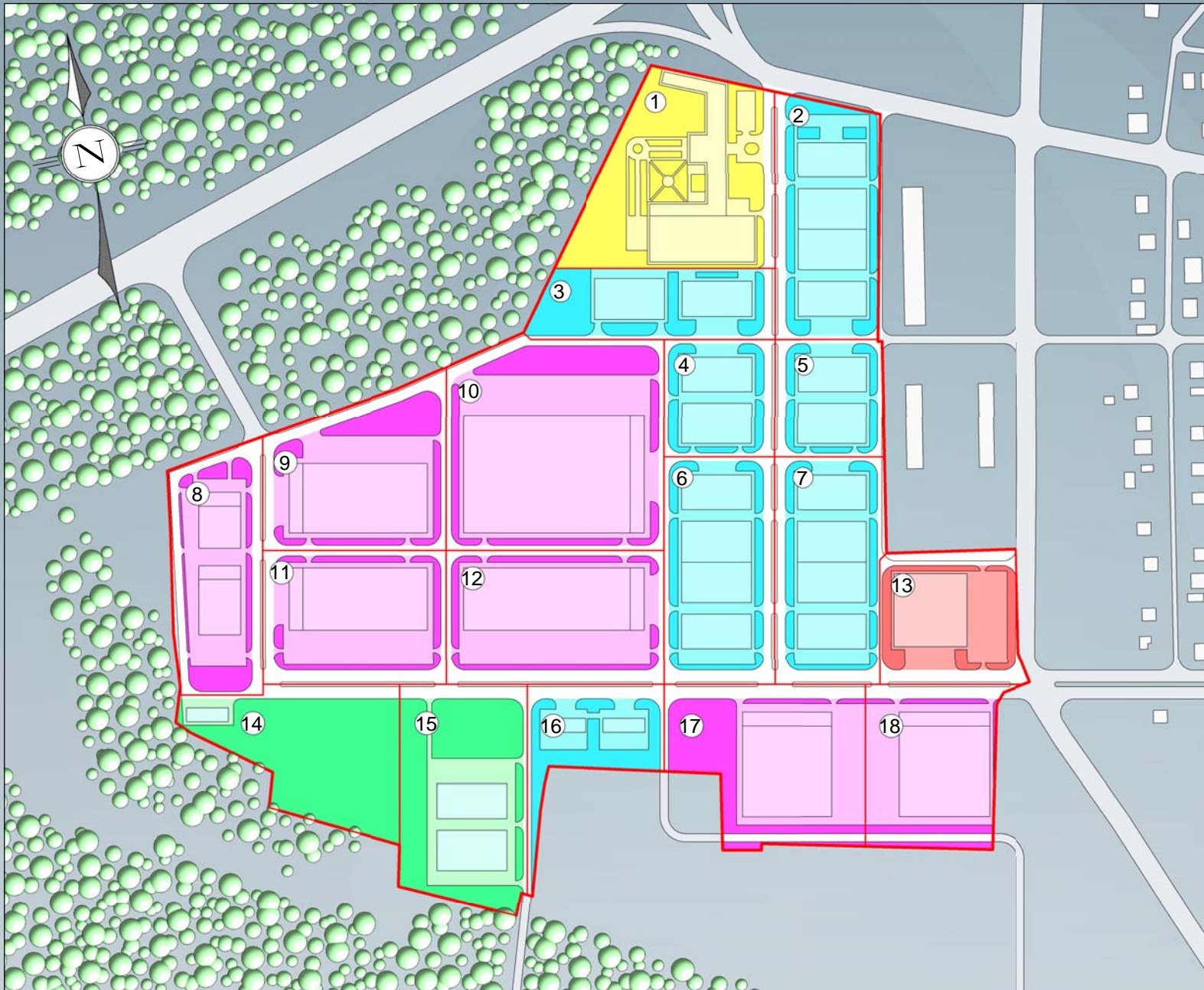

Legend:

- hotel-recreational complex with park zone
- offices
- logistics
- offices with park zone
- public centre

review jointly with page 7

number	Building purpose	Land plat area, sq.m	Building type	Footprint area, sq.m	Number of sections	Number of floors	Total area, sq.m
1	Hotel and recreational complex with park zone	24 900	hotel	3 090	1	3	9 270
			sport complex	3 600	1	1	3 600
2	Office complex	18 600	offices	3 600	2	10	36 000
			parking	4 200	1	4	16 800
3	Office complex	12 490	offices	1 800	1	10	18 000
			parking	2 100	1	4	8 400
4	Office complex	9 660	offices	1 800	1	10	18 000
			parking	2 100	1	4	8 400
5	Office complex	9 600	offices	1 800	1	10	18 000
			parking	2 100	1	4	8 400
6	Office complex	18 720	offices	3 600	2	10	36 000
			parking	4 200	1	4	16 800
7	Office complex	18 460	offices	3 600	2	10	36 000
			parking	4 200	1	4	16 800
8	Logistic complex	15 670	offices	865	2	3	2 595
			warehouse	3 020	2	1	3 020
9	Logistic complex	20 150	offices	720	1	3	2 160
			warehouse	6 480	1	1	6 480
10	Logistic complex	33 730	offices	1 230	1	3	3 690
			warehouse	14 690	1	1	14 690
11	Logistic complex	18 460	offices	650	1	3	1 950
			warehouse	5 830	1	1	5 830
12	Logistic complex	21 890	offices	650	1	3	1 950
			warehouse	7 780	1	1	7 780
13	Public centre	13 890	trading zone	3 970	1	3	11 910
14	Office complex with park zone	18 130	offices	625	1	10	6 250
15	Office complex with park zone	20 460	offices	1 800	1	10	18 000
			parking	2 100	1	4	8 400
16	Office complex	9 740	offices	870	2	10	8 700
17	Logistic complex	21 150	offices	935	1	3	2 805
			warehouse	6 085	1	1	6 085
18	Logistic complex	15 820	offices	935	1	3	2 805
			warehouse	6 085	1	1	6 085

review jointly with page 8

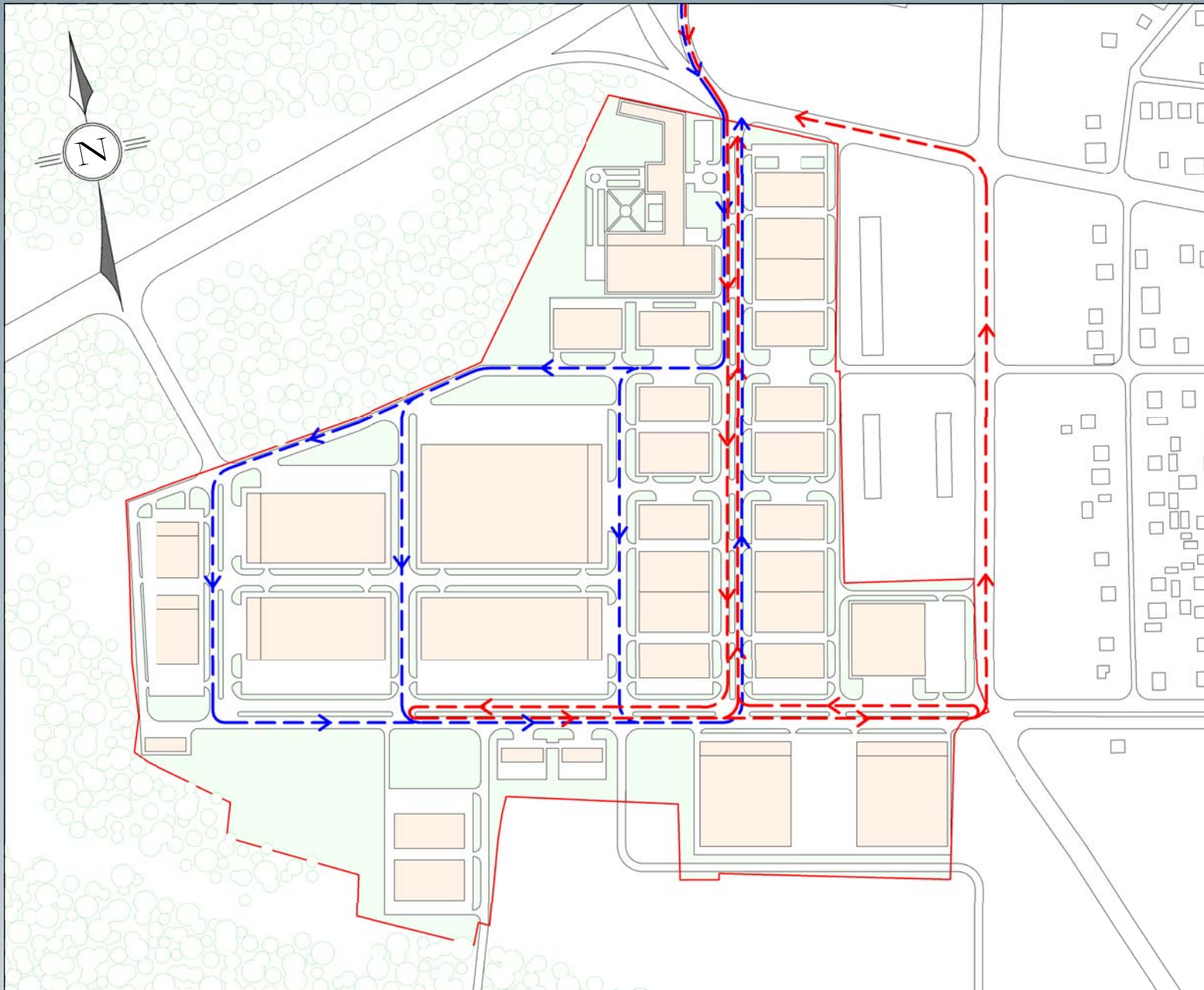

Legend:

← - - - - - passengers cars pathway

← - - - - - trucks pathway

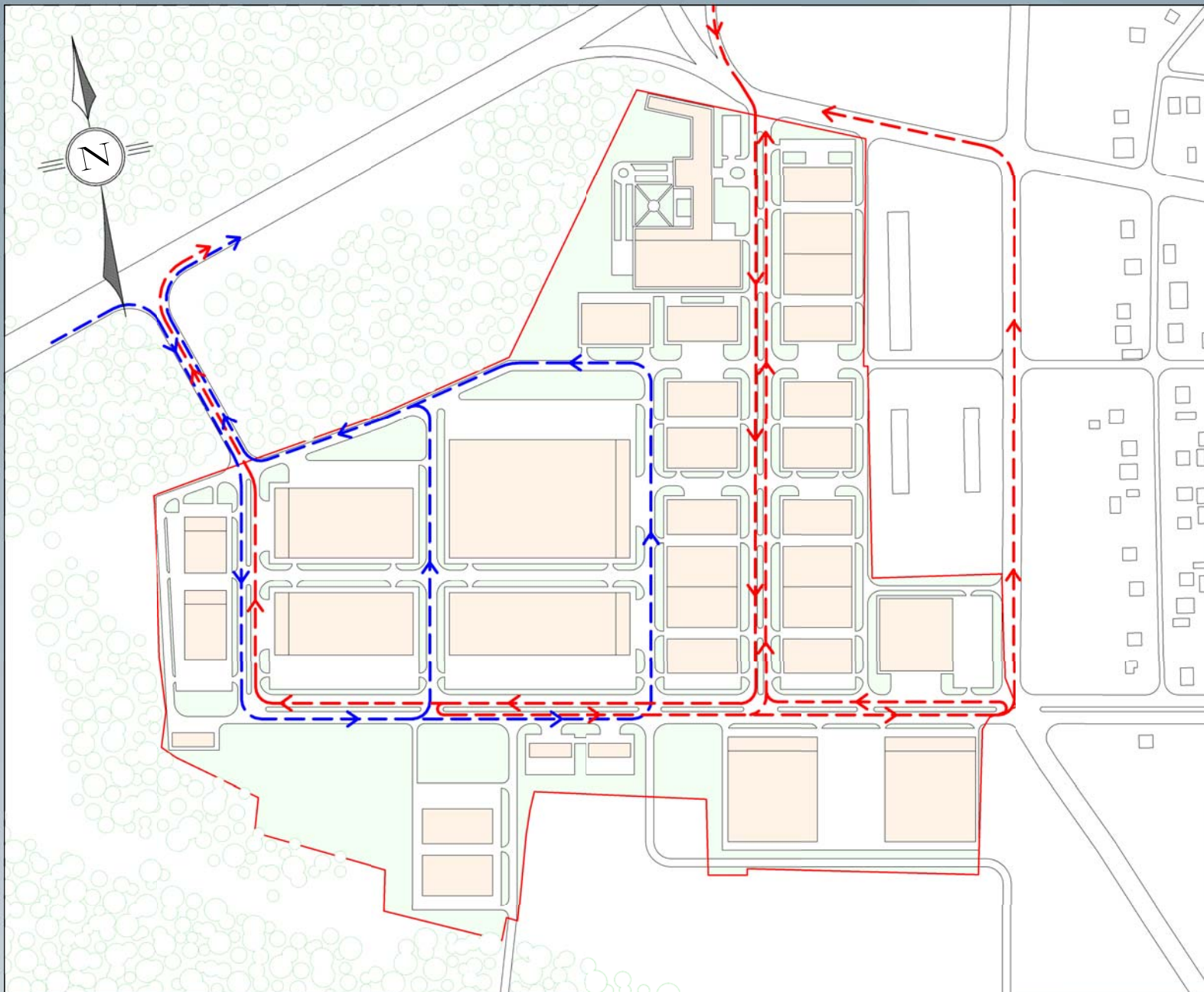

Legend:

← - - - - - passengers cars pathway

← - - - - - trucks pathway

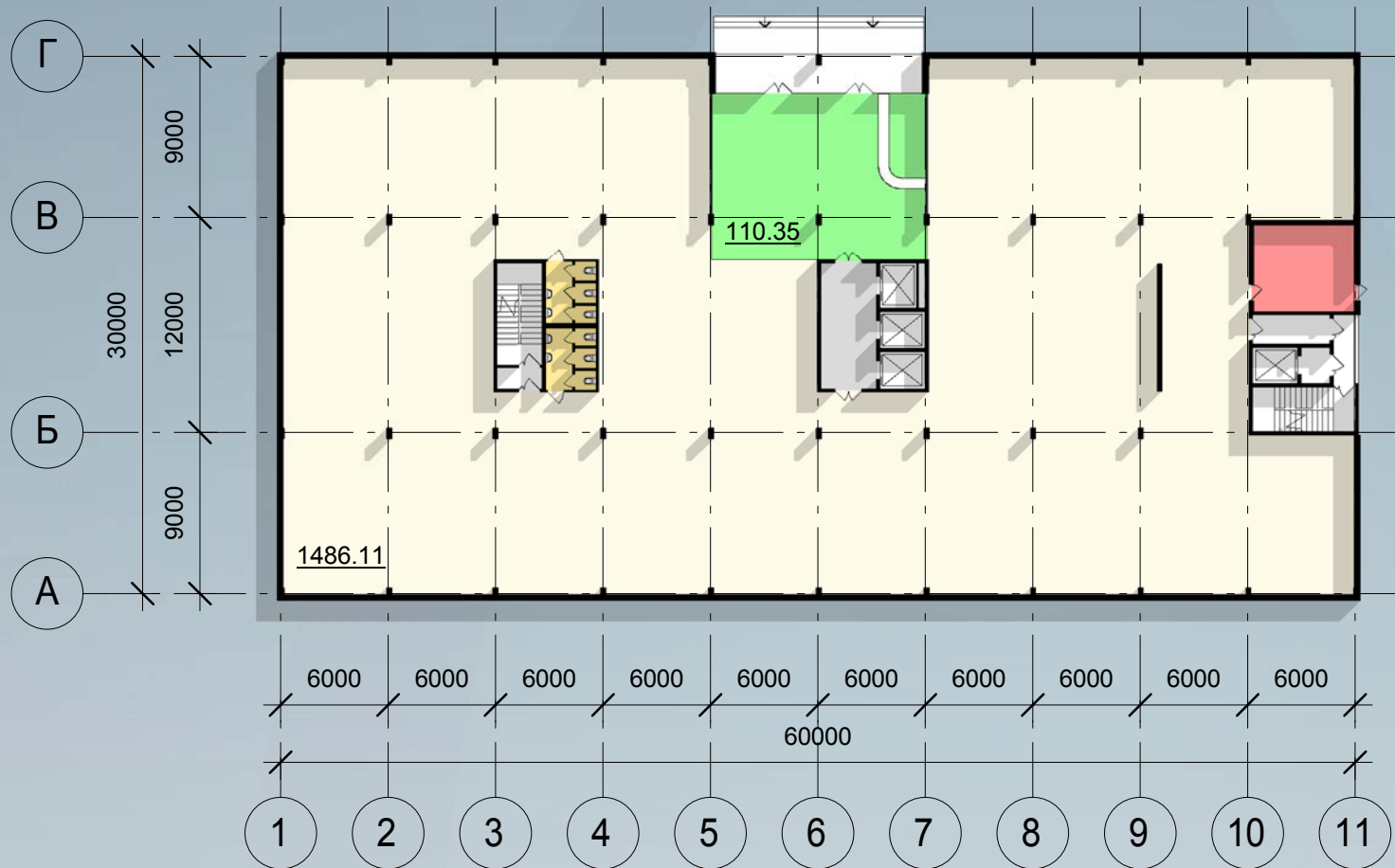

Legend:

- entrance hall
- transit zone
- offices
- service zone
- utility premises

Technical and economics indexes

- | | |
|-------------------------|--------------------|
| - entrance hall | - 110 sq.m |
| - transit zone | - 22 sq.m |
| - offices | - 1486 sq.m |
| - service zone | - 18 sq.m |
| - utility premises | - 27 sq.m |
| Total floor area | - 1664 sq.m |

Legend:

- entrance hall
- transit zone
- dining room
- dining room with kitchen
- offices
- service zone
- utility premises

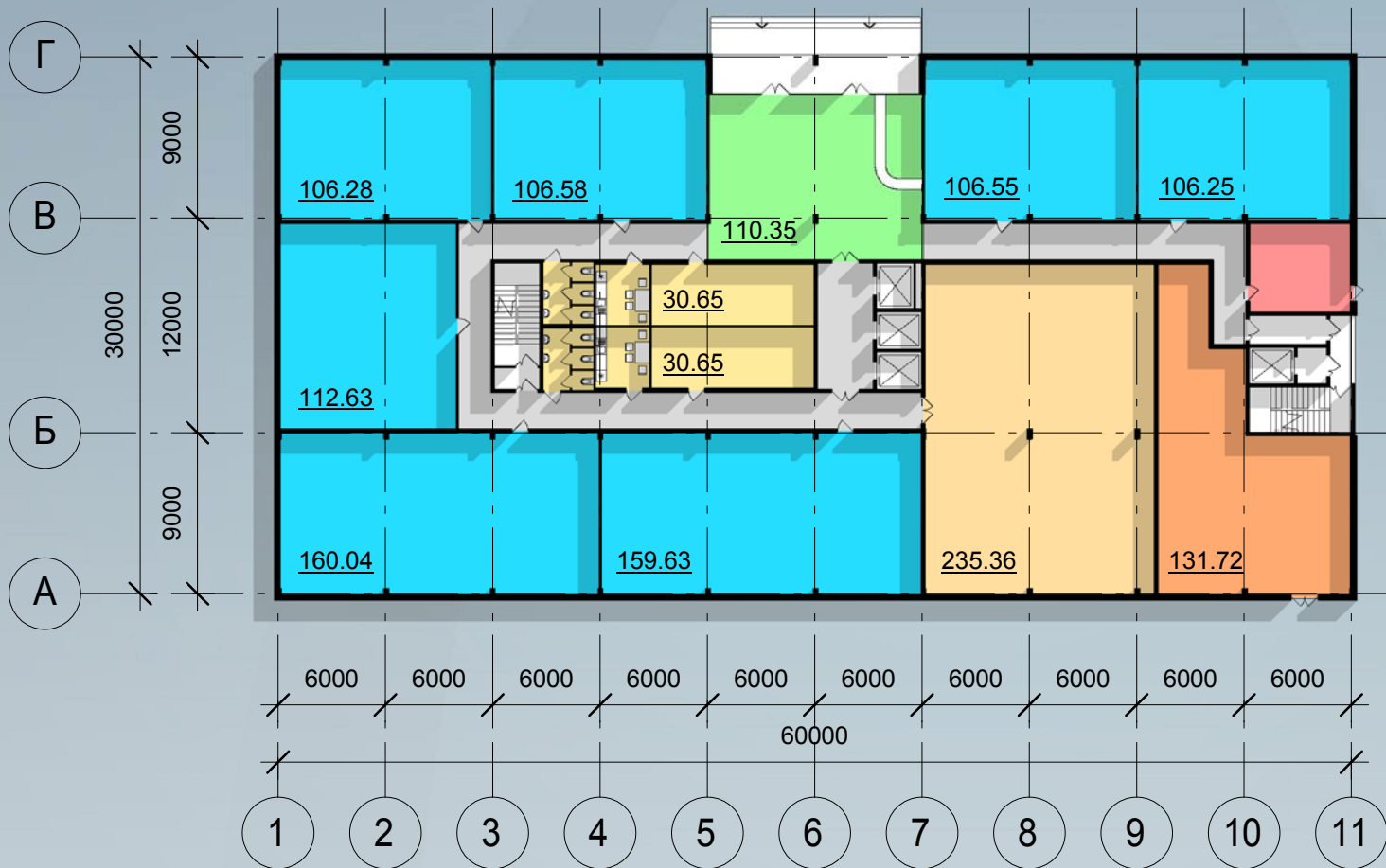

Technical and economics indexes

- | | |
|----------------------------|------------|
| - entrance hall | - 110 sq.m |
| - transit zone | - 114 sq.m |
| - offices | - 858 sq.m |
| - dining room | - 235 sq.m |
| - dining room with kitchen | - 132 sq.m |
| - service zone | - 100 sq.m |
| - utility premises | - 27 sq.m |

Total floor area - 1621 sq.m

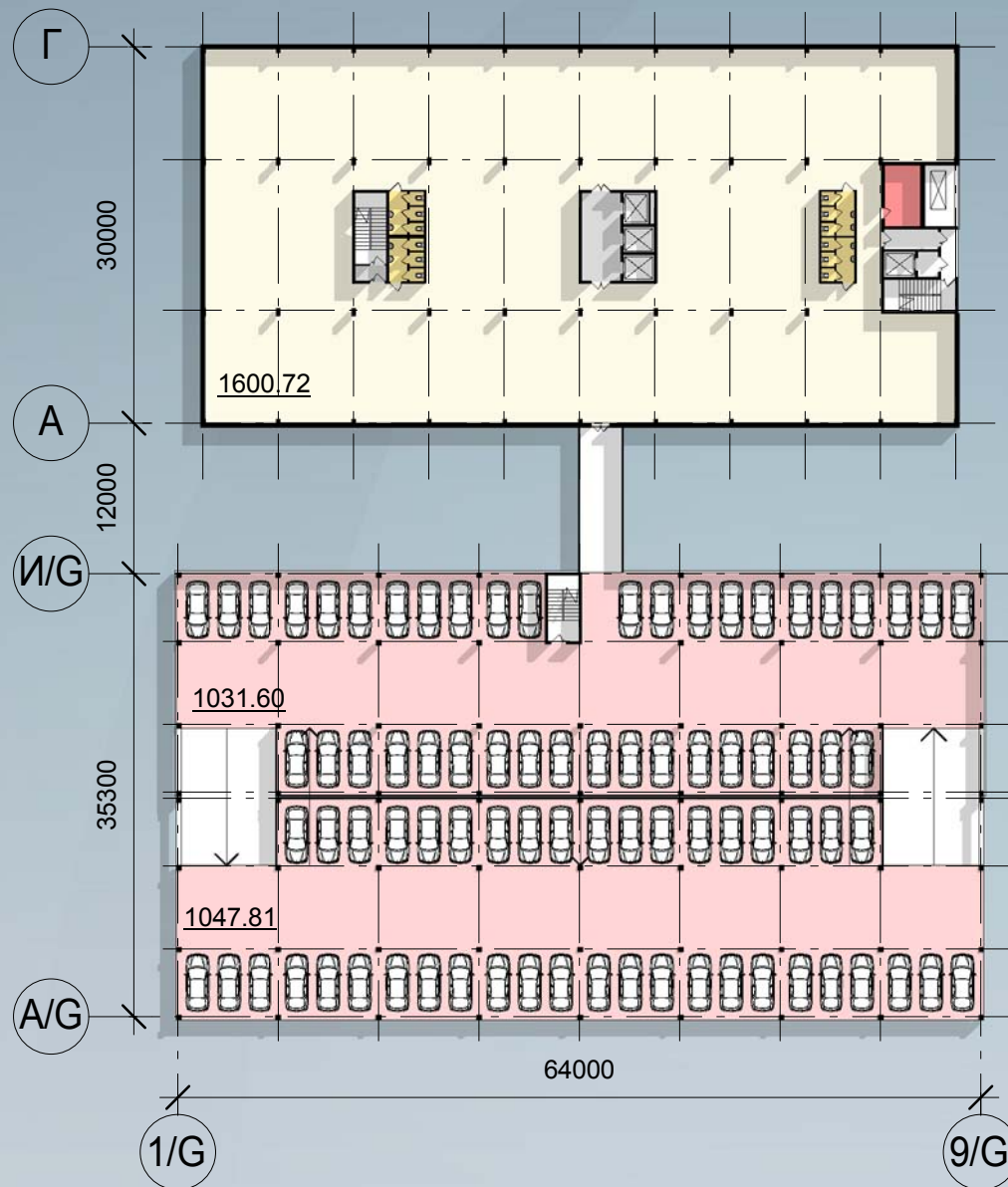

Legend:

- offices
- transit zone
- service zone
- utility premises
- parking

Technical and economics indexes

- offices	- 1 601 sq.m
- transit zone	- 25 sq.m
- service zone	- 37 sq.m
- utility premises	- 14 sq.m
- parking	- 2 080 sq.m
	82 places
one car place approximate area	- 25 sq.m
Total floor area	- 1 677 sq.m

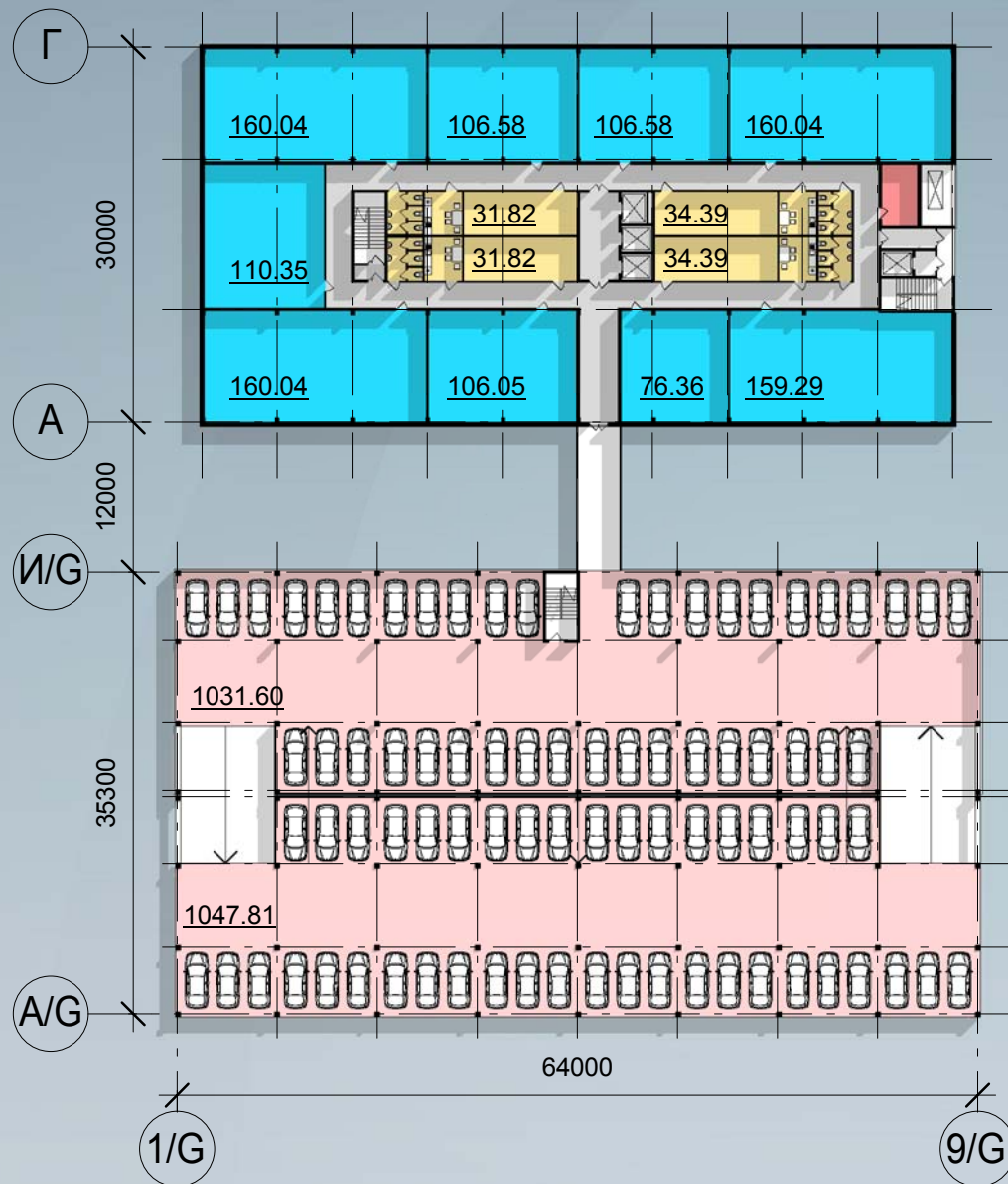

Legend:

- offices
- transit zone
- service zone
- utility premises
- parking

Technical and economics indexes

- offices - 1 145 sq.m
- transit zone - 259 sq.m
- service zone - 211 sq.m
- utility premises - 14 m2
- parking - 2 080 sq.m
82 places
- one car place
approximate area - 25 sq.m
- Total floor area - 1 629 sq.m

Legend:

- office zone
- transit zone
- service zone
- utility premises

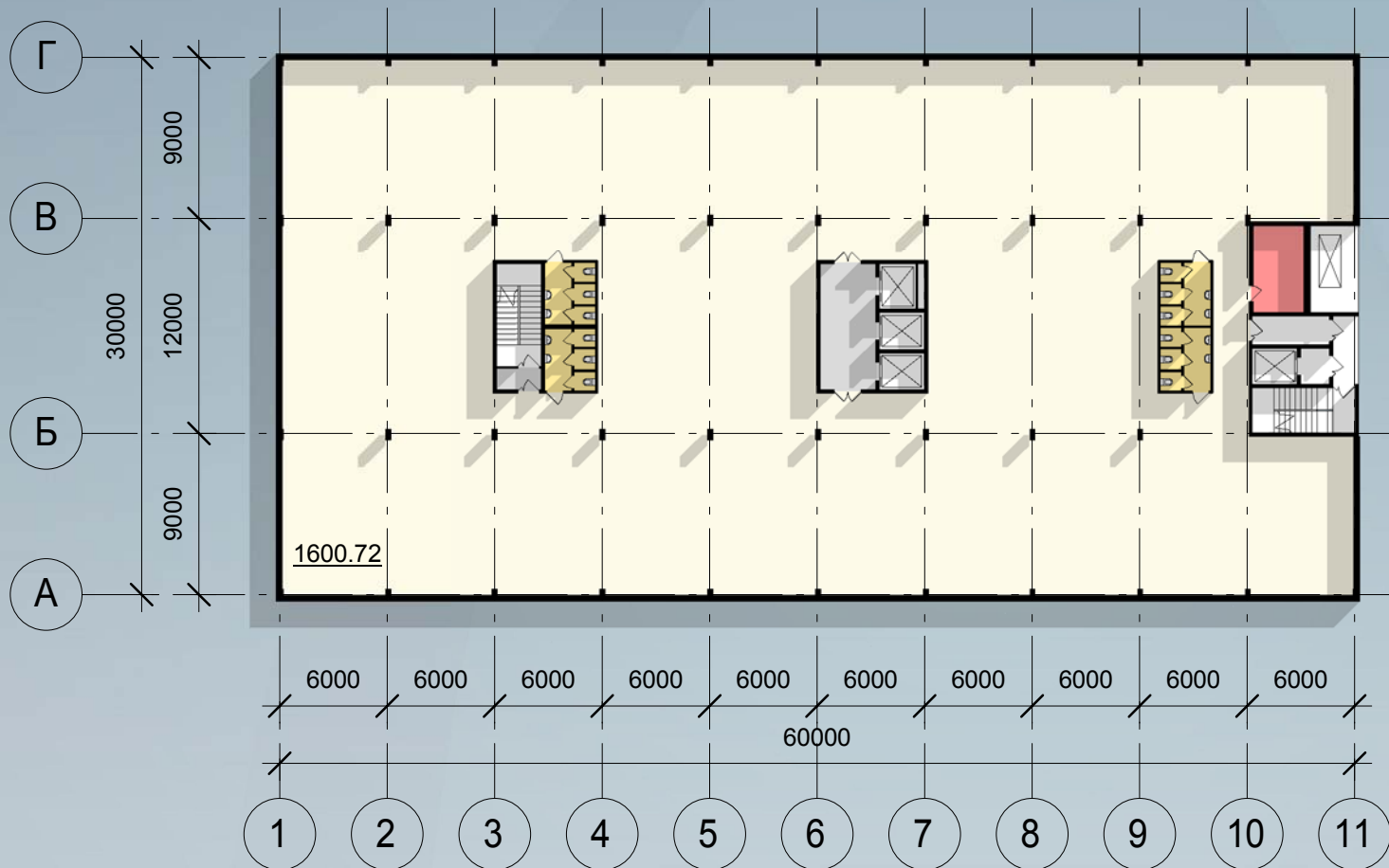

Technical and economics indexes

- office zone	- 1 601 sq.m
- transit zone	- 25 sq.m
- service zone	- 37 sq.m
- utility premises	- 14 sq.m
Total floor area	- 1 677 sq.m

Legend:

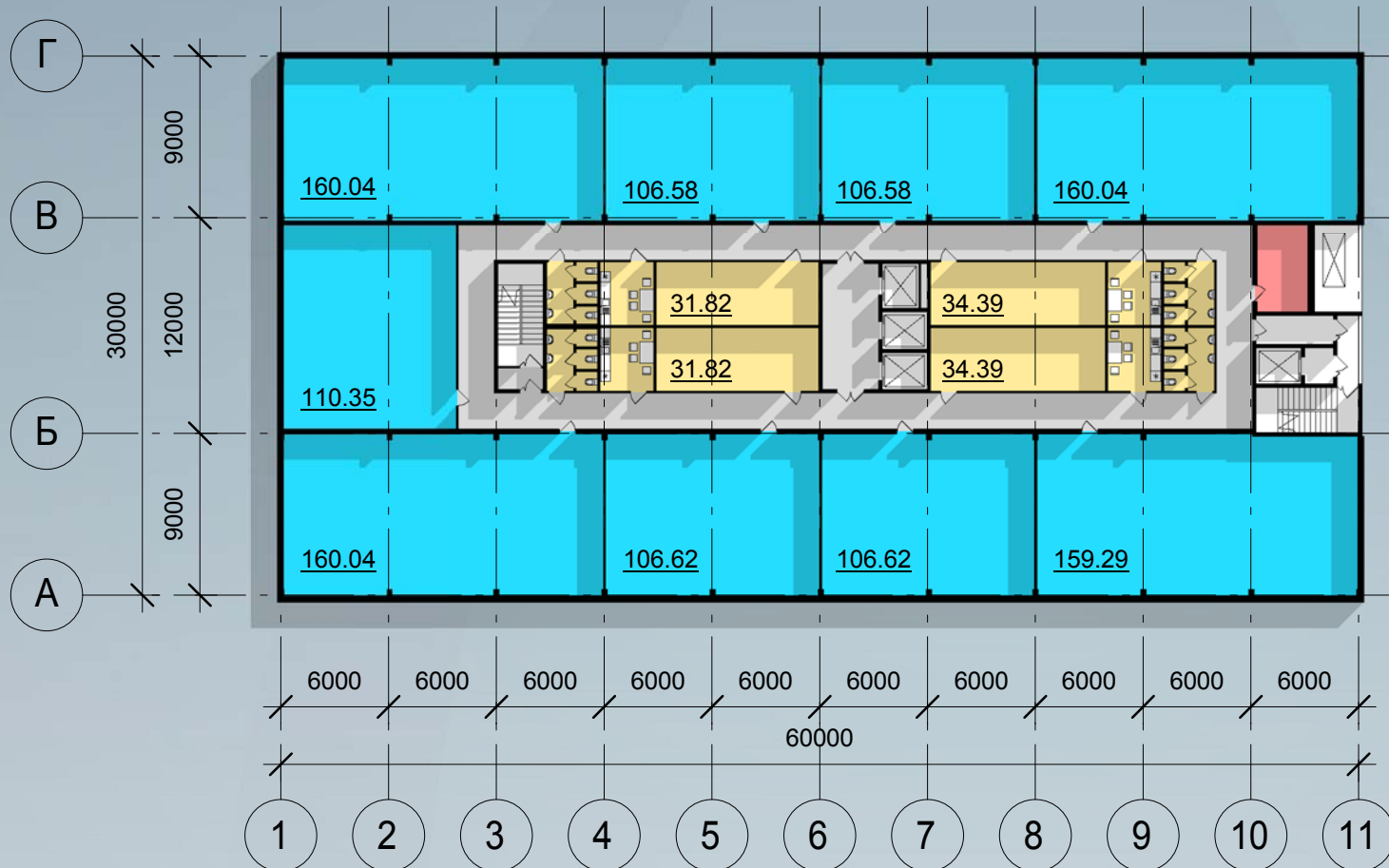

- offices
- transit zone
- service zone
- utility premises



Technical and economics indexes

- offices	- 1 176 sq.m
- transit zone	- 231 sq.m
- service zone	- 211 sq.m
- utility premises	- 14 sq.m
Total floor area	- 1 632 sq.m

Legend:

-  - "Rooftop" ventilation system
-  - ventilation channels

